

CLUTCH

GI

MA

EM

LC

EC

FE

CL

MT

AT

TF

PD

FA

RA

BR

ST

RS

BT

HA

EL

IDX

SECTION **CL**

MODIFICATION NOTICE:

TD25 and TD25Ti engine models have been added for Turkey, Argentina and Brazil.

CONTENTS

CLUTCH SYSTEM	2	Operating Cylinder.....	5
Clutch Pedal	3	CLUTCH RELEASE MECHANISM	7
INSPECTION AND ADJUSTMENT	4	CLUTCH DISC AND CLUTCH COVER	8
Adjusting Clutch Pedal	4	SERVICE DATA AND SPECIFICATIONS (SDS)	9
HYDRAULIC CLUTCH CONTROL	5	General Specifications.....	9
Clutch Master Cylinder	5	Inspection and Adjustment	9

CLUTCH SYSTEM

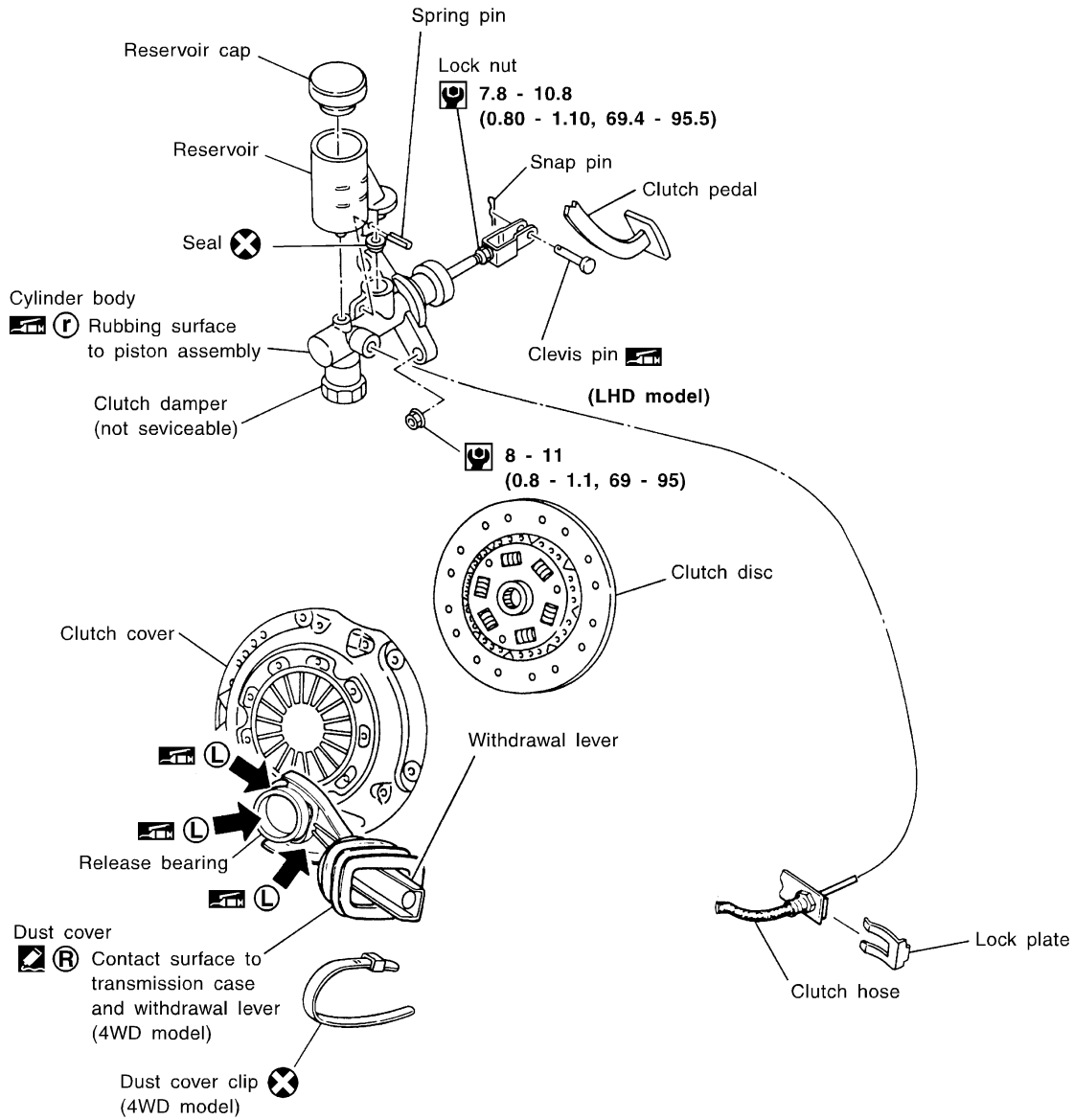

2WD models with TD25 engine

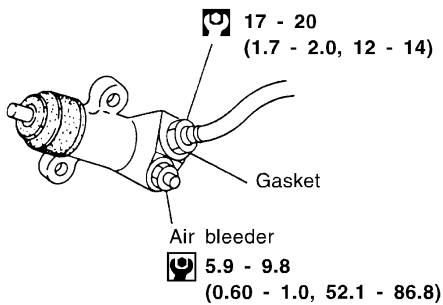

4WD models with TD25Ti engine

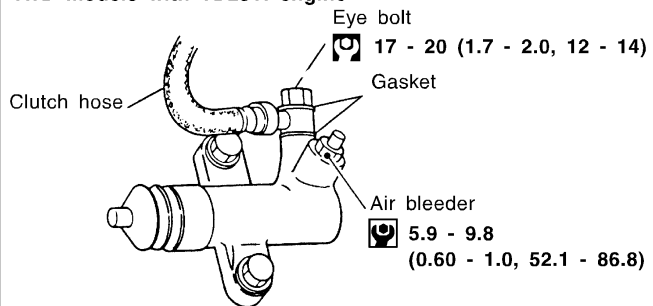

: N•m (kg-m, ft-lb)
 : N•m (kg-m, in-lb)

: Apply recommended sealant, Nissan genuine part: KP115-00100, Three Bond TB1212 or equivalent.

: Apply lithium-based grease including molybdenum disulphide.

: Apply rubber lubricant.

CLUTCH SYSTEM

Clutch Pedal

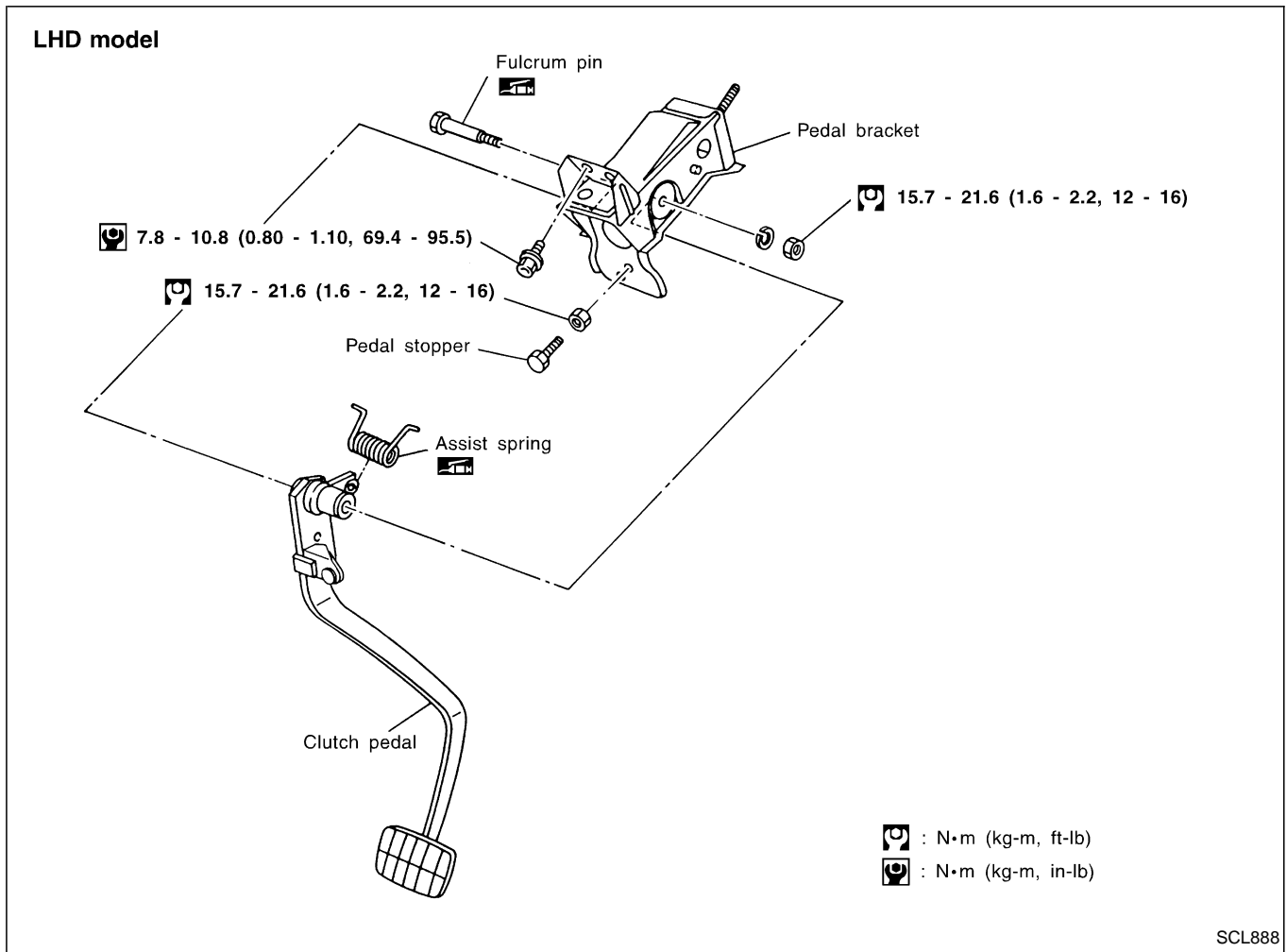

GI

MA

EM

LC

EC

FE

CL

MT

AT

TF

PD

FA

RA

BR

ST

RS

BT

HA

EL

IDX

Adjusting Clutch Pedal

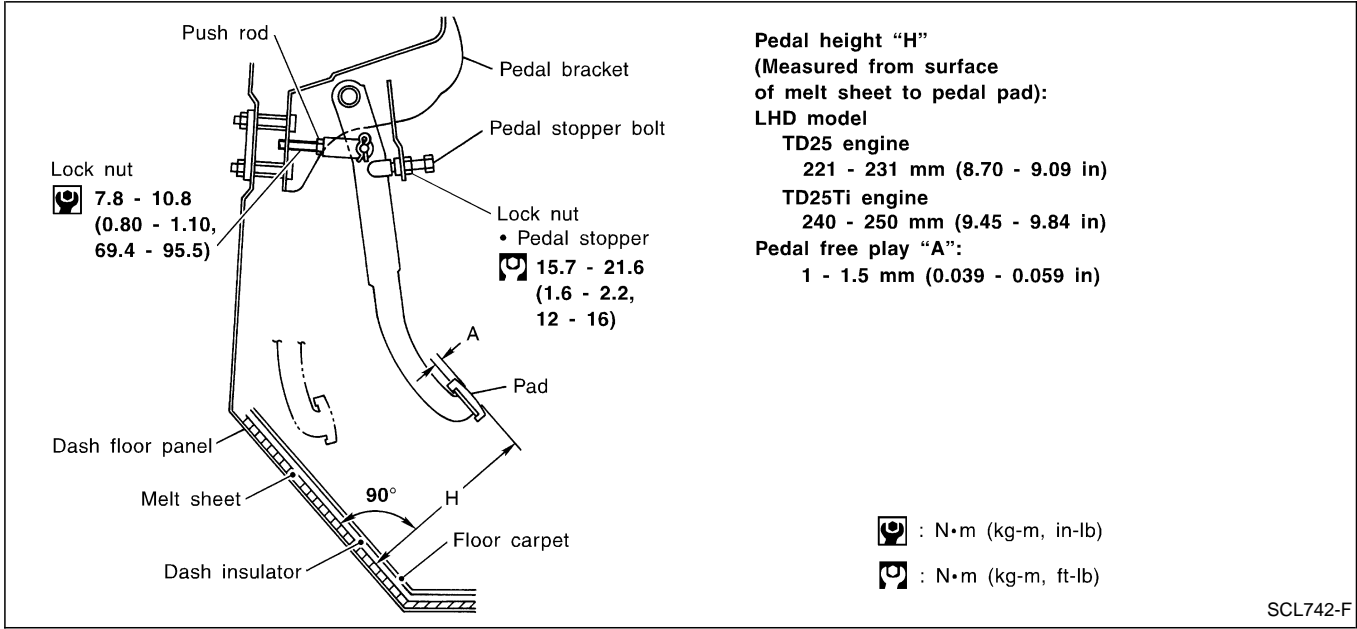

HYDRAULIC CLUTCH CONTROL

Clutch Master Cylinder

SEC. 305 LHD model

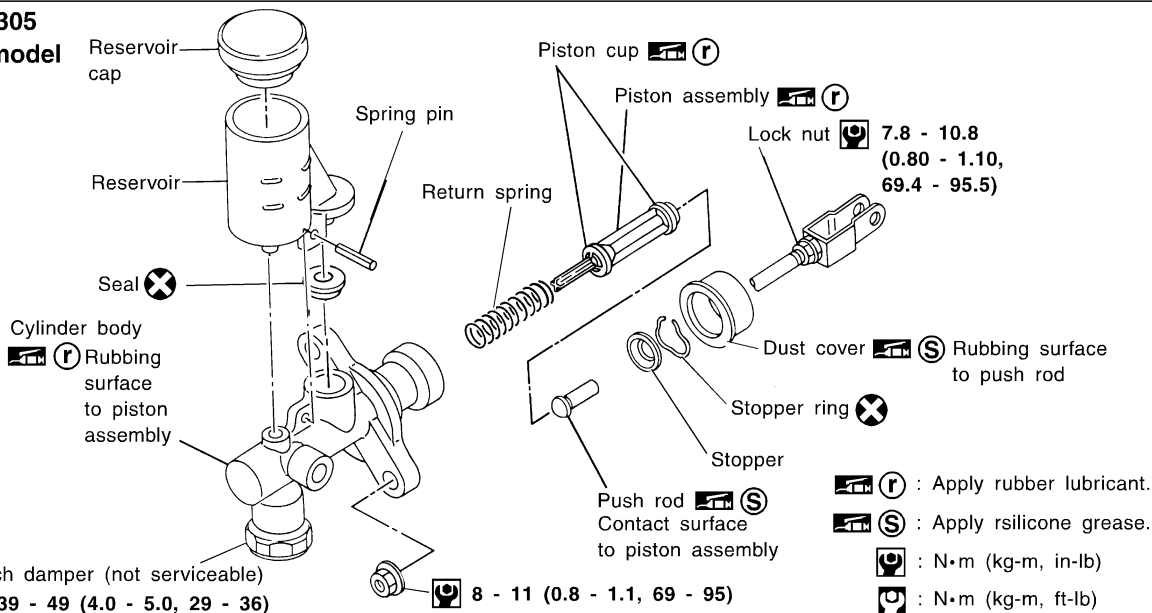

SCL889

Operating Cylinder

SEC. 306 2WD models

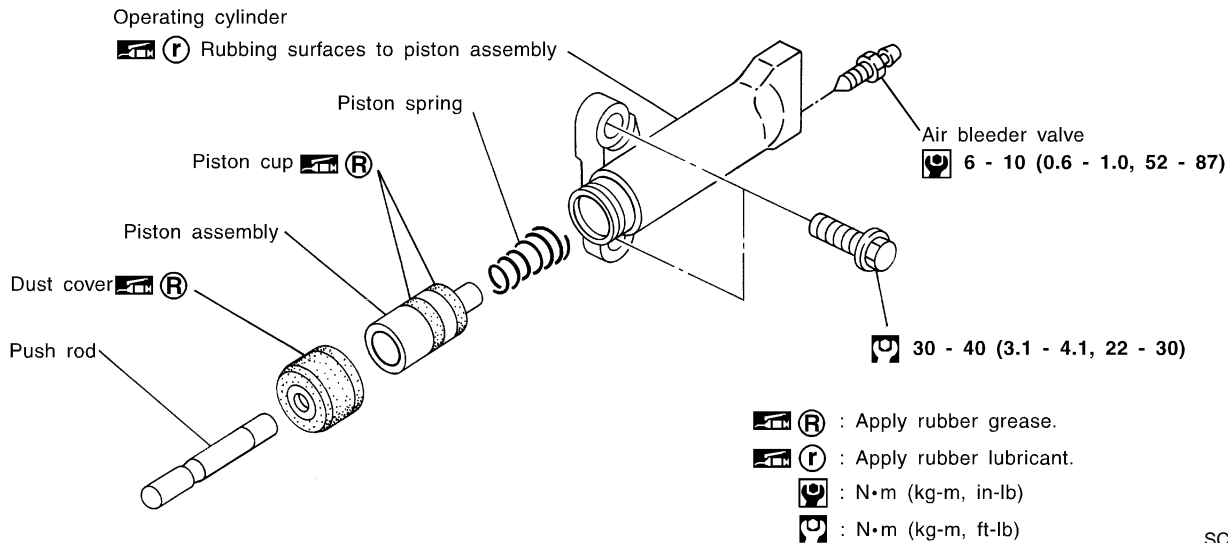

SCL745-A

GI
MA
EM
LC
EC
FE
CL
MT
AT
TF
PD
FA
RA
BR
ST
RS
BT
HA
EL
IDX

HYDRAULIC CLUTCH CONTROL

Operating Cylinder (Cont'd)

SEC. 306

4WD models

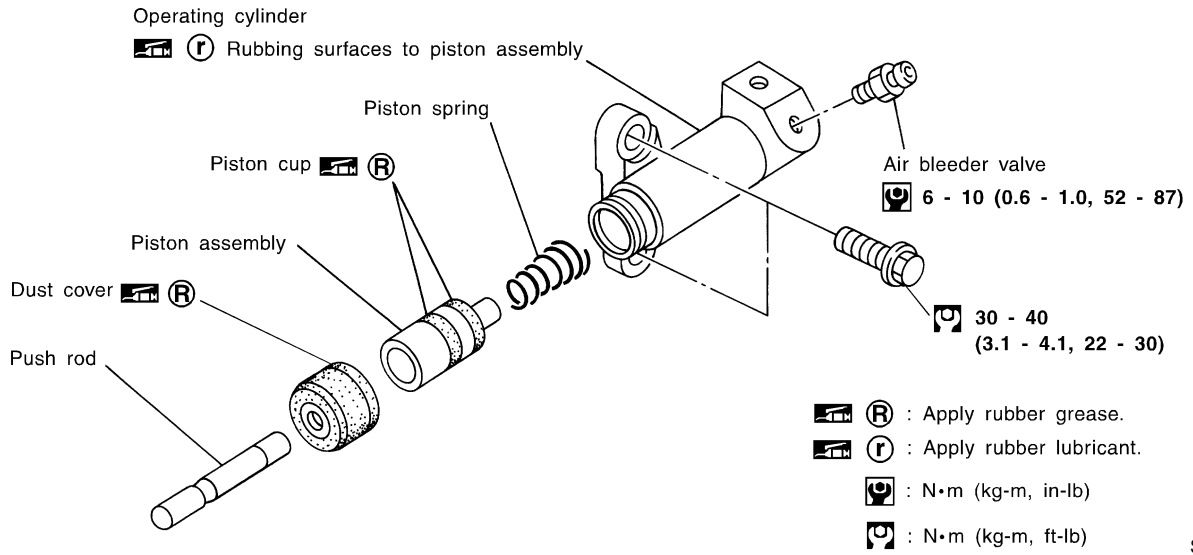

CLUTCH RELEASE MECHANISM

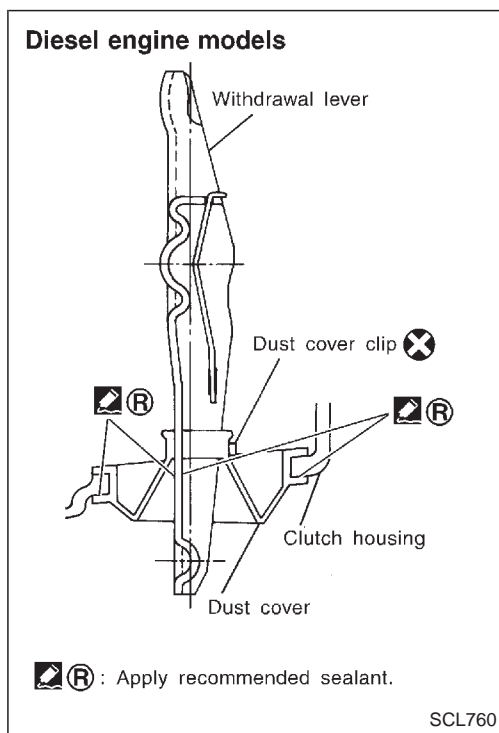
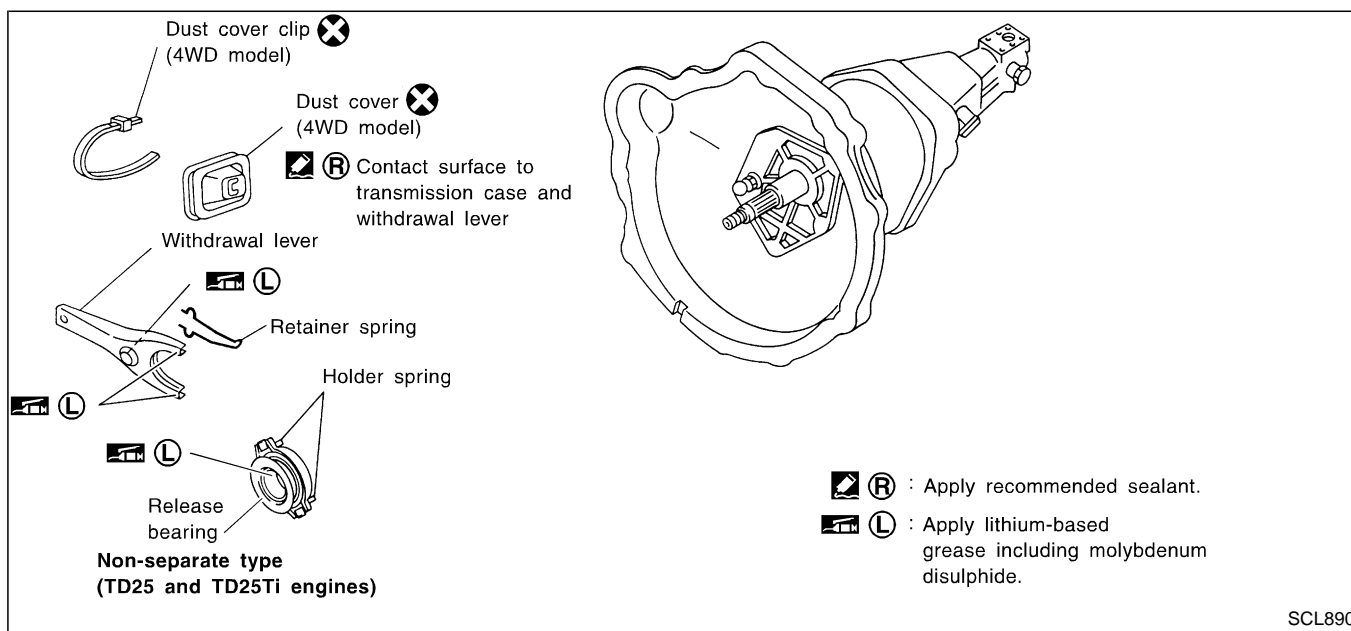

WATERPROOF — for 4WD model

- Apply recommended sealant to contact surface of transmission case dust cover and withdrawal lever, then install dust cover clip.

Recommended sealant: Nissan genuine part (KP115-00100) or equivalent.

GI
MA
EM
LC
EC
FE
CL
MT
AT
TF
PD
FA
RA
BR
ST
RS
BT
HA
EL
IDX

CLUTCH DISC AND CLUTCH COVER

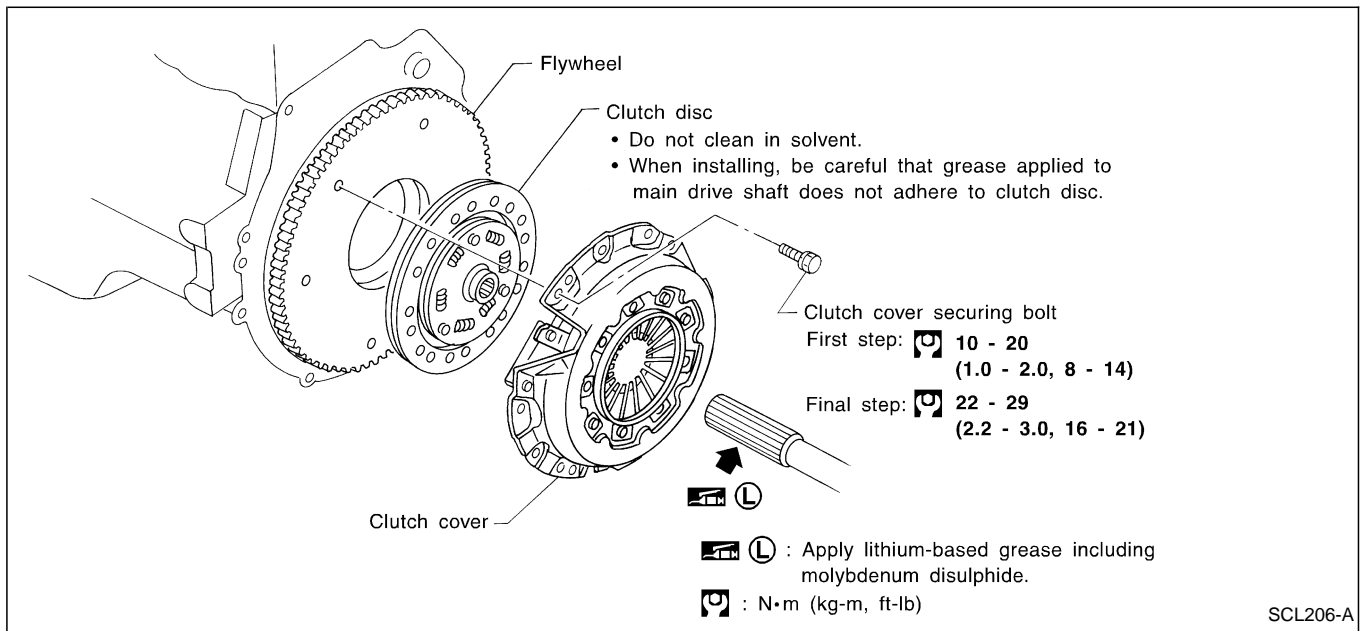

SERVICE DATA AND SPECIFICATIONS (SDS)

General Specifications

CLUTCH MASTER CYLINDER (All models)

Inner diameter	mm (in)	15.87 (5/8)
----------------	---------	-------------

CLUTCH OPERATING CYLINDER

Inner diameter	mm (in)	
TD25 engine model		17.46 (11/16)
TD25Ti engine model		19.05 (3/4)

CLUTCH DISC

Model	240	250
Engine	TD25	TD25Ti
Facing size mm (in) (Outer dia. x inner dia. x thickness)	240 x 160 x 3.5 (9.45 x 6.30 x 0.138)	250 x 160 x 3.5 (9.84 x 6.30 x 0.138)
Thickness of disc assembly With load mm (in)	7.5 - 7.9 (0.295 - 0.311) With 4,904 N (500 kg, 1,103 lb)	7.9 - 8.3 (0.311 - 0.327) With 5,884 N (600 kg, 1,323 lb)

CLUTCH COVER

Model	240	250
Engine	TD25	TD25Ti
Full load N (kg, lb)	3,923 (400, 882)	5,884 (600, 1,323)

Inspection and Adjustment

CLUTCH PEDAL

Unit: mm (in)

Pedal height "H**"	
LHD model	
TD25 engine model	221 - 231 (8.70 - 9.09)
TD25Ti engine model	240 - 250 (9.45 - 9.84)
Pedal free play (at clevis pin)	1 - 1.5 (0.039 - 0.059)

*: Measured from surface of melt sheet to pedal pad

CLUTCH DISC

Unit: mm (in)

Model	240	250
Engine model	TD25	TD25Ti
Wear limit of facing surface to rivet head	0.3 (0.012)	0.3 (0.012)
Runout limit of facing	1.0 (0.039)	1.0 (0.039)
Distance of runout check point (from the hub center)	115 (4.53)	120 (4.72)
Maximum backlash of spline (at outer edge of disc)	1.0 (0.039)	1.0 (0.039)

CLUTCH COVER

Unit: mm (in)

Model	240	250
Engine model	TD25	TD25Ti
Diaphragm spring height	37.5 - 39.5 (1.476 - 1.555)	36.5 - 38.5 (1.437 - 1.516)
Uneven limit of diaphragm spring toe height	0.7 (0.028)	0.5 (0.020)

GI

MA

EM

LC

EC

FE

CL

MT

AT

TF

PD

FA

RA

BR

ST

RS

BT

HA

EL

IDX